

ROOM LAYOUT

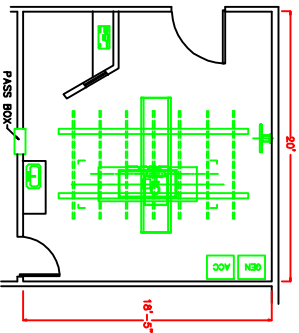

UTILITY PLAN

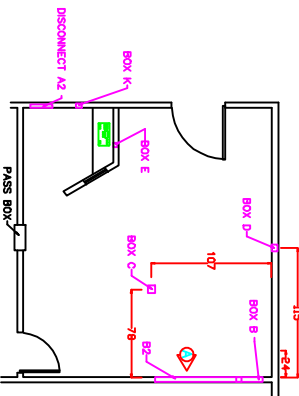

BARRIER PLAN MECHANICAL PLAN

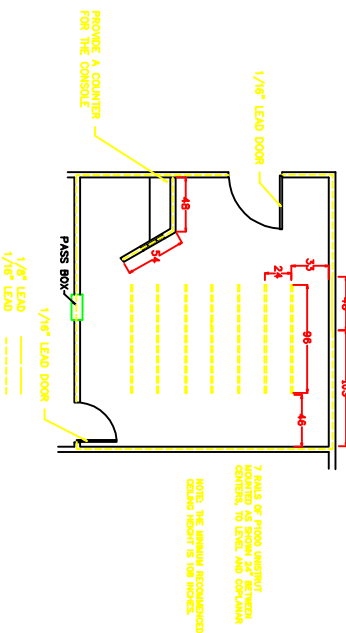

SPECIFICATIONS:

- PANEL A 400 VAC 3 PHASE SERVICE DISCONNECT, MOUNTED AS SHOWN, CENTER 5' ABOVE THE FINISHED FLOOR. DISCONNECT TO PROVIDE A 100 AMP 3 WIRE CIRCUIT TO BOX B.
- BOX B 1 1/2" x 1 1/2" x 6" JUNCTION BOX LOCATED AS SHOWN, 12" ABOVE THE FINISHED FLOOR. OVERSIZE COVER TO CONTAIN 2 3" CHASE BUSINES.
- BOX C SQUARE D CLASS 8000 (OR EQUIVALENT) WALL DUCT FROM BOX B UP TO AND ALONG THE CEILING, COVER TO CONTAIN 1 3" CHASE BUSINAM.
- BOX D 4" x 4" x 6" JUNCTION BOX LOCATED AS SHOWN, 12" ABOVE THE FINISHED FLOOR.
- BOX E 4" x 4" x 6" JUNCTION BOX LOCATED AS SHOWN, 12" ABOVE THE FINISHED FLOOR.
- BOX K 4" x 4" x 6" JUNCTION BOX LOCATED AS SHOWN, 5' ABOVE THE FINISHED FLOOR.

DETAIL A

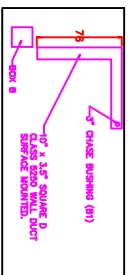

NOTES:

- 1) ALL WIRE MUST BE COPPER STRANDED.
- 2) ALL MATERIAL SPECIFIED TO BE SUPPLIED BY OTHERS.
- 3) PROVIDE DUPLEX RECEPTACLES AS SHOWN ON THE UTILITY PLAN.

LEAD BARRIER:

LEAD TO BE INSTALLED IN THE AREAS SHOWN ON THE BARRIER PLAN TO A HEIGHT OF 7 FEET FROM THE FLOOR. ALL JOINTS MUST BE OVERLEAFED AND ALL PENETRATIONS INCLUDING BURNER FLUE, LEAD MUST OVERLEAF ALL DOOR AND WINDOW FRAMES.

SCHEMATIC

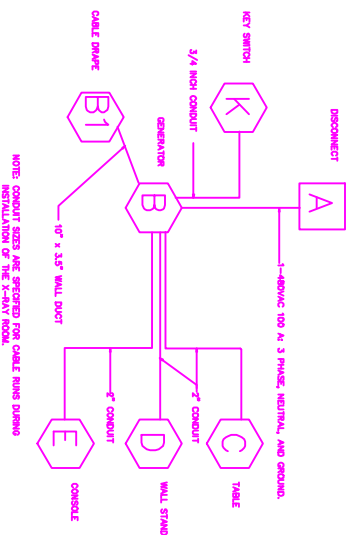

GRAND X-RAY SUPPLIES INC.

GRAND X RAY ROOM 1 DEL 80KW TOMO ROOM	
DATE: 6-12-10	SHEET 1 OF 1
SCALE: 1/4" = 1' 0"	APPROVED BY:
DRAWN BY: R. UNDERHILL EE	
GRAND X-RAY 823 OTTAWA N.W. CHESTNUT AND OLYMPIA PHONE: (616) 459 0146 FAX: (616) 459 3128	